

THE AMBERLY

J, 10th Floor

1 Bedroom

1 Bathroom

Indoor Area: 754 Square Feet

Terrace: 675 Square Feet

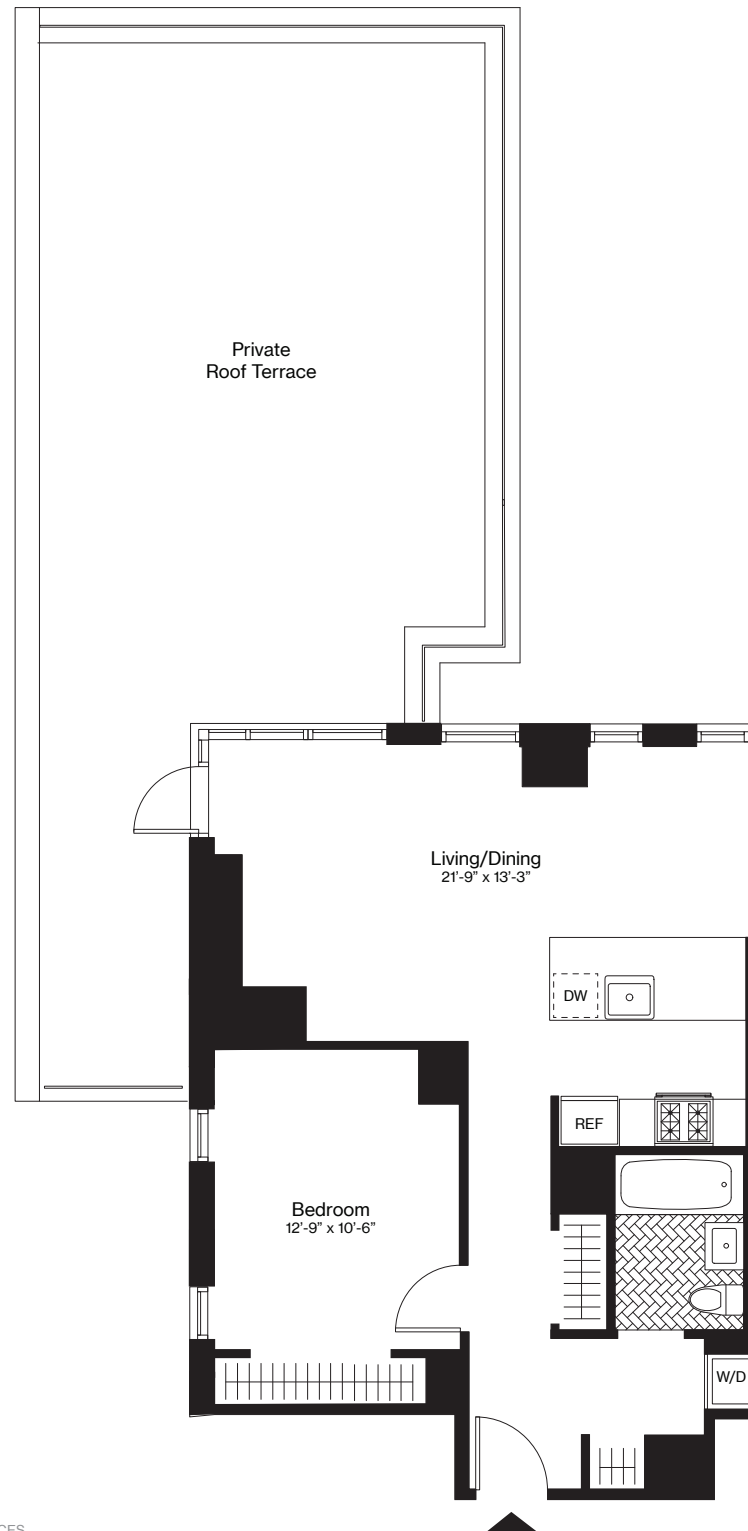

The Amberly
120 Nassau St.
Brooklyn, NY
11201

Visit our Leasing Office:
718.246.1200
theamberlybk.com
info@theamberlybk.com

 ALL DIMENSIONS ARE APPROXIMATE AND SUBJECT TO NORMAL CONSTRUCTION VARIANCES AND TOLERANCES.

